

Welcome to the global air quality community!

You've taken the first step toward cleaner air!

**[Click here to watch
the demo video](#)**



Get to know your **Community Monitor**

Understand what you are breathing and share it with the world.

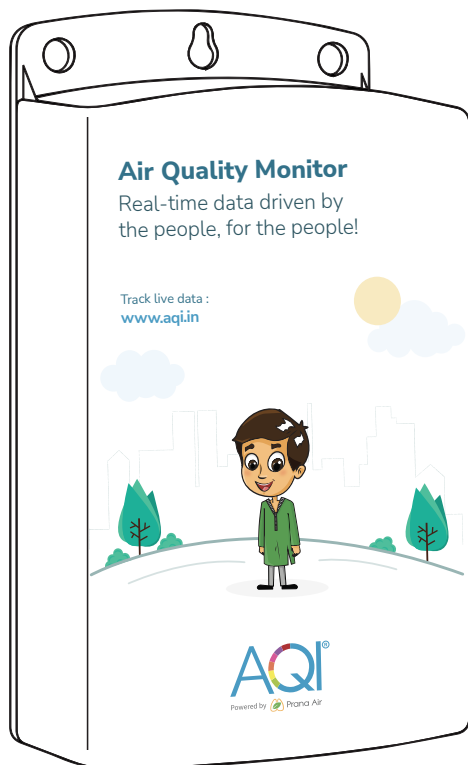

What's in the box

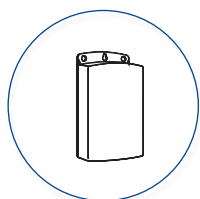

Community Monitor

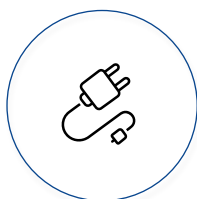

Adapter & Cable

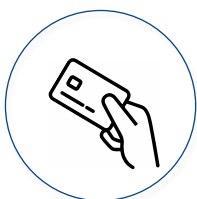

Instruction Manual Card

Preparing the Device



STEP 1 :

Gently press on the left and right sides of the monitor's bottom, then carefully slide the plate out to detach it from the monitor.

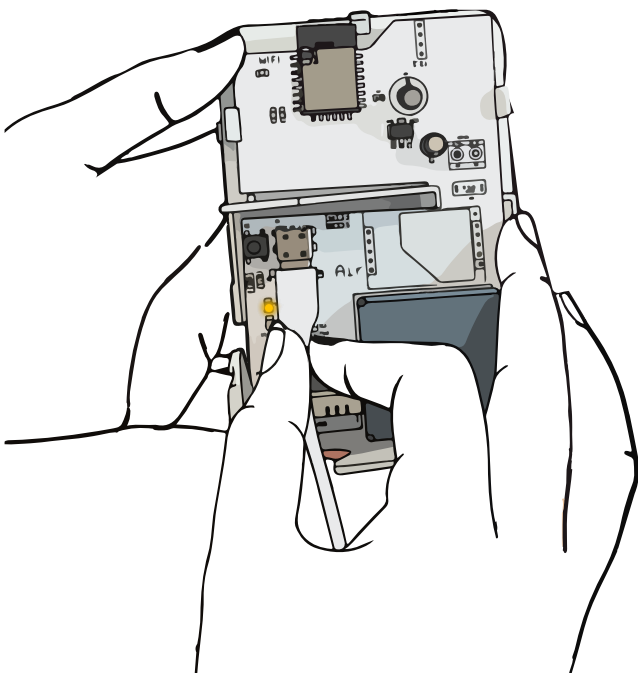

STEP 2 :

Next, locate the Type-C inlet on the PCB plate, gently insert the provided cable, and then carefully slide the PCB plate back into the monitor.



A stable yellow light will appear when the cable is plugged in.



A blinking red light indicates the device is online and transmitting data to the server.

No red light means the monitor is offline and there is a WiFi issue.

Mounting Options

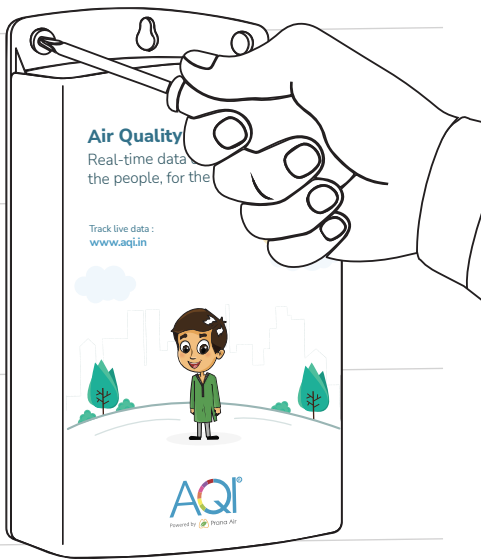

STEP 3 :

With Screws

Use **two screws** to securely mount the monitor on an exterior wall of the house.

NOTE:

Make sure the monitor is mounted outside the house, preferably in a balcony or terrace, for accurate air quality measurement."

OR

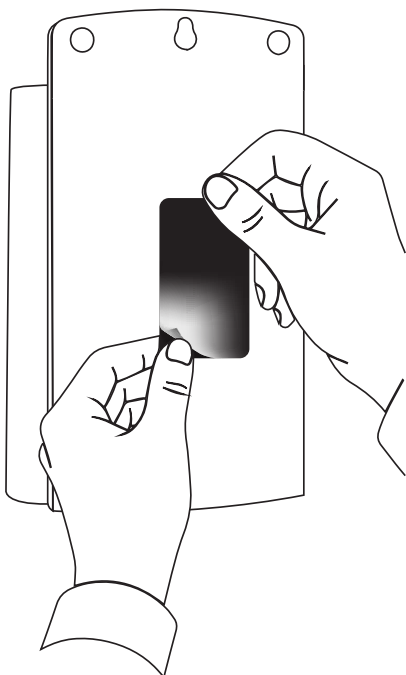

Carefully remove the black plastic layer from the tape

STEP 3 :

With Double Sided Tape

The monitor comes with a **Pre-attached double-sided tape** for wall mounting. Simply peel off the protective backing from the tape and firmly press the monitor against the wall to secure it in place.

NOTE:

1. Ensure the tape is applied in the correct positions to securely hold the monitor.
2. Clean the wall surface thoroughly before applying placing the monitor.
3. Decide the placement carefully, as repositioning may reduce the tape's adhesive strength.

Final Setup

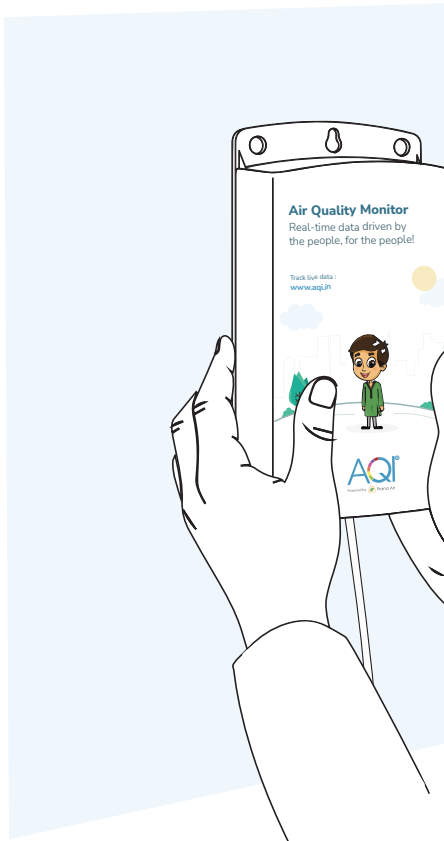

STEP 4 :

Install the monitor on the clean wall of the house, preferably in a balcony, terrace, or other outdoor location.



STEP 5 :

Plug the device into a power source using a **Type-C USB cable**.

Adding the Monitor in the AQI APP

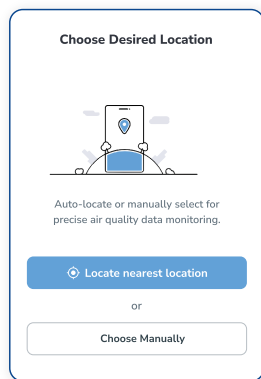
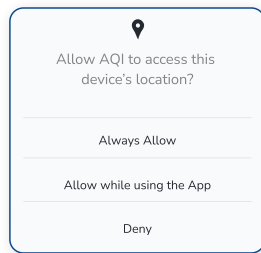
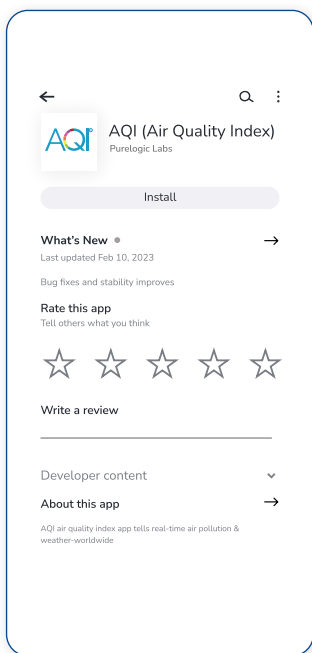

1

Download and install the **AQI App** on your phone (*available on Google Play Store for Android and the App Store for iOS*). After installing, open the app and allow all the necessary permissions.

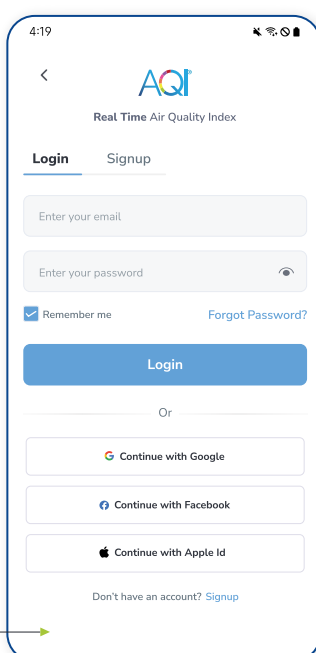
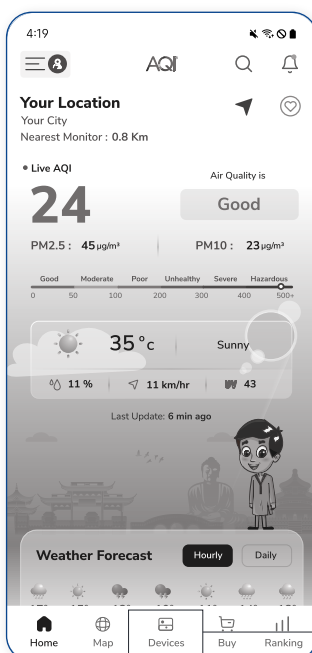

2

Then, Click on **"Devices"** icon showing in the bottom of home screen. Then **Sign up** to create your account or **Log in** if you already have an account.

Note: Ensure your device is connected to a 2.4 GHz Wi-Fi network only. To do this, switch your personal Wi-Fi to the 2.4 GHz band before setting up the device.

3 Ensure that your phone's **Bluetooth** is turned on before continuing.

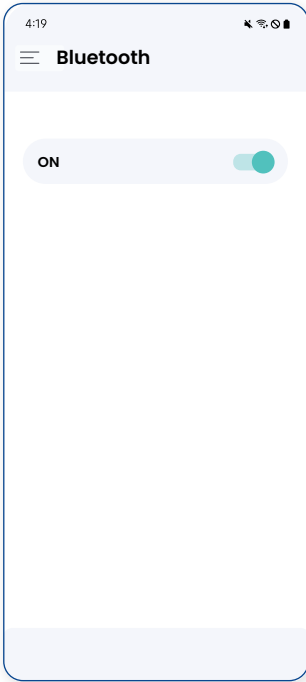

4 After successful login, Tap on **"Devices"** and then click on the **"Add Device"** button.

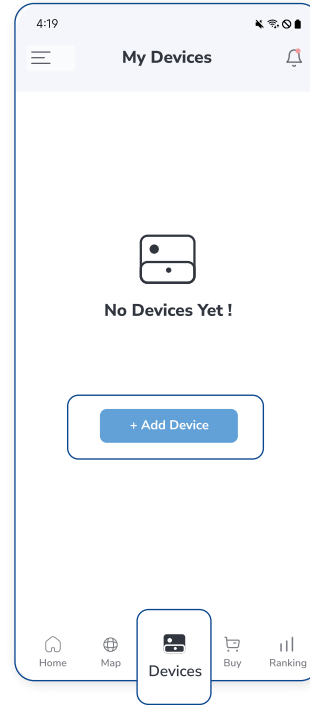

5 After enabling Bluetooth, select the device id displaying there.

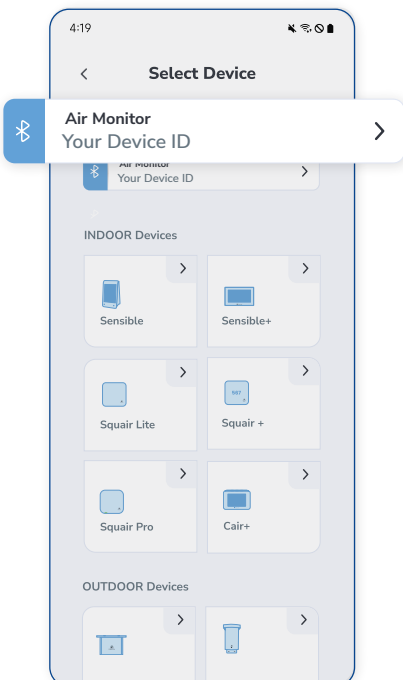

6 On the AQI app screen, choose the available **WiFi network** and enter the corresponding **password** to establish the connection.

Note: Ensure your device is connected to a 2.4 GHz Wi-Fi network only. To do this, switch your personal Wi-Fi to the 2.4 GHz band before setting up the device.

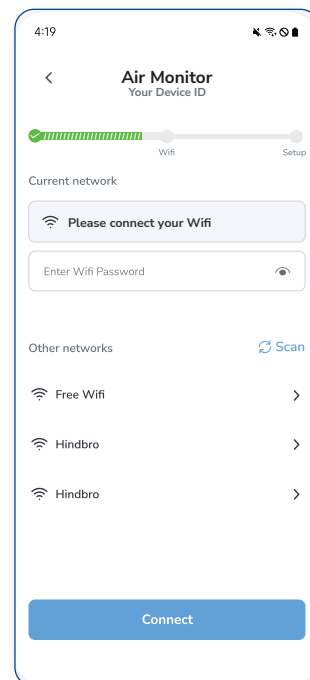

- 7 Once the WiFi connection is established, a **"Connected"** status will appear. Wait for the status to change to **"Online"** before proceeding.

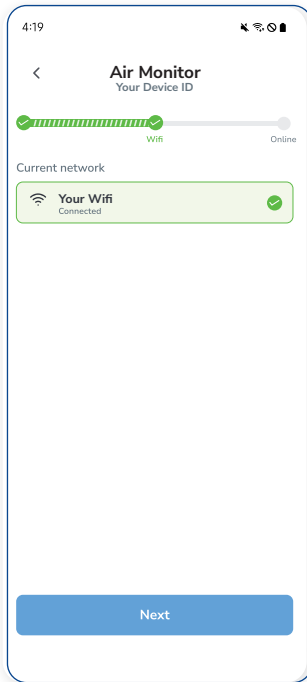

- 8 Make sure **location services** are enabled on your device. Without location services, the monitor cannot be added.

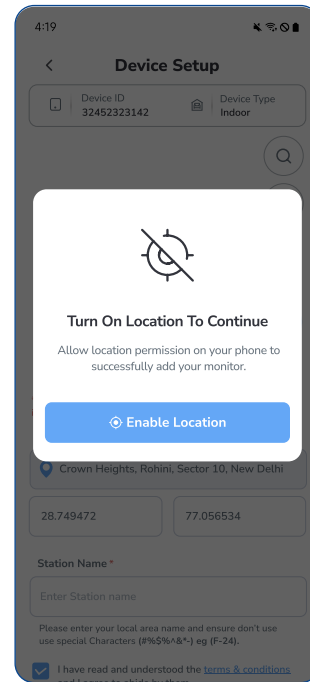

- 9 On the **'Device Setup'** page, details will auto-fill. Ensure you are in the correct location, within Wi-Fi range, and with stable power.

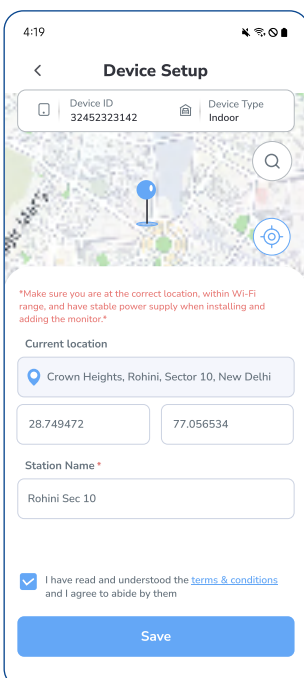

- 10 Upload **clear images** of the installed monitor for verification. This will make your AQI data publicly available on our website.

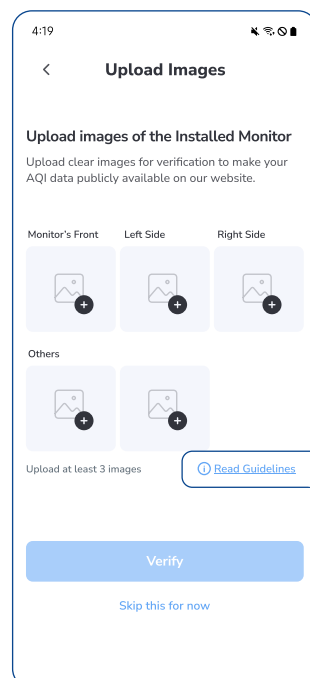

NOTE:
If you don't understand the image upload process, click on **'Read Guidelines'**.

11 Image upload guidelines are given below. Please make sure to follow them.

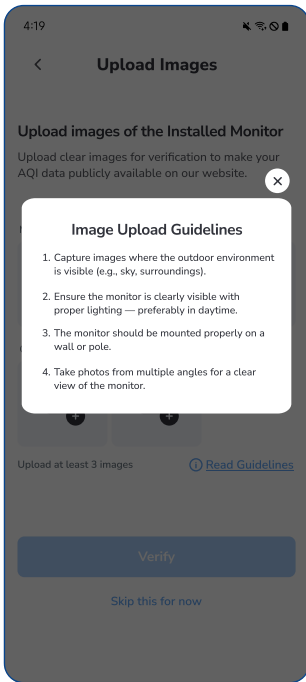

12 Once all images are uploaded, click the 'Verify' button.

NOTE:
Even if you skip this step now, you will be required to upload it later. Without completing this step, the device cannot be added as a public station.

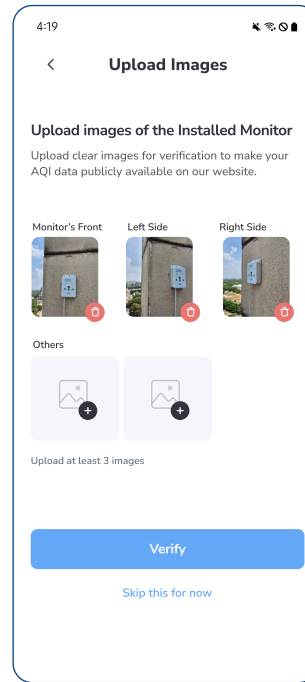

REFERENCE IMAGES

13 Once the upload is complete, click on "Verify" and your images will begin the verification process.

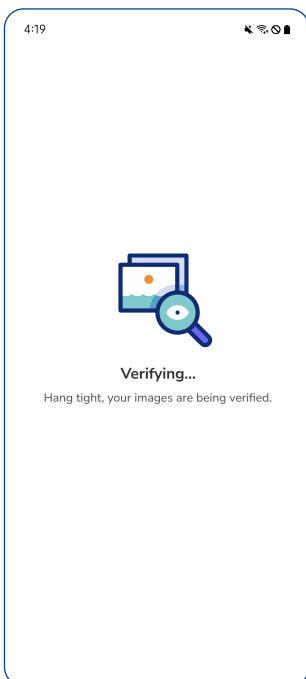

14 Once your images are successfully verified, you will receive the confirmation.

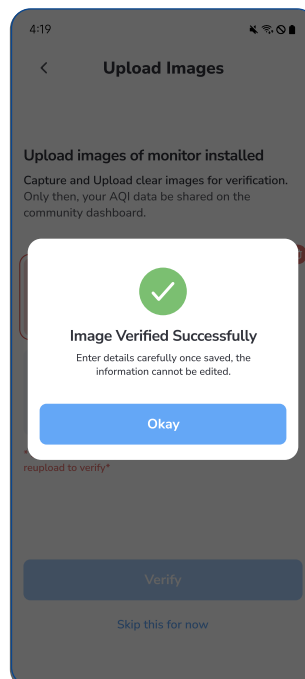

If your images are not verified after multiple attempts

If you are unable to upload images after multiple attempts and have reached the verification limit, don't worry. Simply contact us, and our team will manually review and verify them for you.

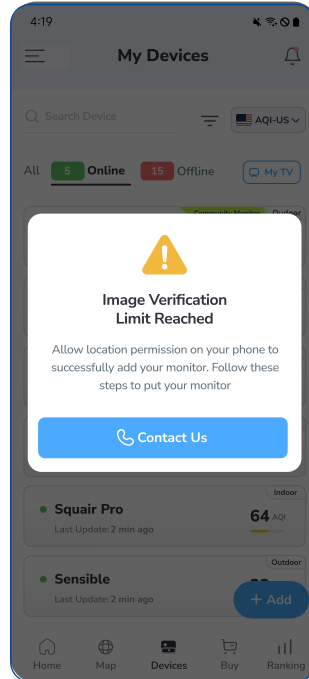
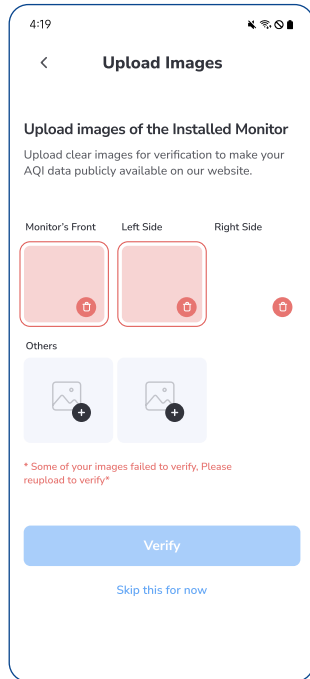

- 15 Device added successfully. Check it under 'My Devices'. If offline after 5 mins, verify power and Wi-Fi.

- 16 Click on your device in "My Devices" to get a detailed view of the monitored data.

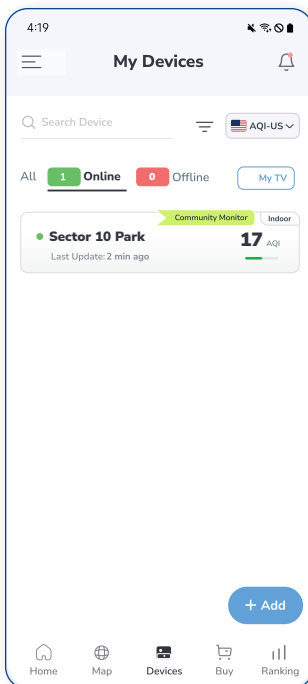

NOTE:

Please ensure the device is successfully added to the AQI app and has established an online connection.

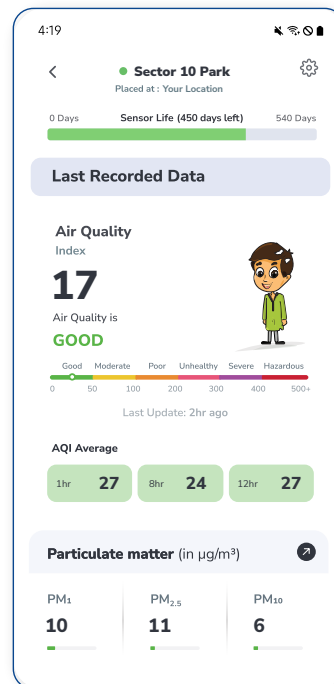

[Still have questions? Click here to watch the demo video.](#)

Safety Guide, Terms & Repair

— Safety Guide

Read and follow the user manual before using the device.

Avoid exposing the device to extremely high temperatures, and humidity. And Make sure to turn on the device properly.

To avoid damage, keep the device away from harmful liquids. It can damage the device.

Take appropriate precautions if you are aware of any potential hazards or risks related to the specific environment you are monitoring.

Preventive measures: If the gadget detects high levels of pollutants or other potentially hazardous substances, take precautionary measures such as opening windows or leaving the area.

When connecting to the wifi network and the AQI app, kindly read the instructions carefully.

It is important to only use Prana Air repair services to fix the device. If the air quality monitor is not functioning properly, do not attempt to repair it yourself.

Accessories: The user has the option to use an alternative adapter (with the same power rating) and USB cable.

Store the air quality monitor in a cool, dry place when not in use. This will help prevent damage to the device and extend its lifespan. Do not drop, shake, or knock the device. Violent usage may damage the screen or the internal circuit.

— Warranty Terms

The device comes with 6 Months warranty against manufacturing defects.

A valid proof of purchase is required to be eligible for repairs or replacements.

Warranty will be void in case of physical damage.

— Sending and Retrieving the Device for Repair

The customer must provide the necessary information, such as name, contact number, and fault description, to complete the repair work order.

If payment is made by cheque, the device can only be retrieved after the cheque has cleared.



Instruction Manual
THANK YOU

CONTACT

Address

706, 7th floor, Crown
heights, Rohini Sec-10,
New delhi-110085, India

Phone

(+91) 73918-73918

Online

Email : info@purelogic.in
Website : www.pranair.com
